

LC50 SNAP LEVEL CONTROL

The LC50 is a float operated liquid level control. With a maximum working pressure of 500 psi it is a great choice for low to medium pressure applications. Its adjustable range allows it to be used as either a hi/low alarm or a traditional level controller.

The LC50 contains a replaceable 3-way block and bleed pilot featuring a soft seat for a bubble tight shutoff. It is available in 2" threaded, 4" or 5" union and 4" grooved connection sizes. Two stainless steel float sizes are available with other sizes and arm lengths by request. For sour service a NACE option is available.



Specifications

- Sizes:** Threaded: 2", Union: 4" and 5", Grooved: 4"
- Pressure Rating:** 500 psi
- Temperature Range:** -20° F to 400° F (-29° C to 204° C)
- Pilot Connections:** 1/4" NPT
- Max Pilot Pressure:** 250 psi
- Materials:**
 - Body:** WCB Steel
 - Float:** Stainless Steel (2" X 6" Standard, 3 1/2" X 6" Optional)
 - Arm:** Stainless Steel (10" Standard, 6" Optional)
 - Shaft:** Stainless Steel
 - Bushings:** Brass, Stainless Steel (Optional)
 - Seals:** Buna, Viton® (Optional)
 - Pilot Body:** Aluminum

Dimensions

Dimensions in inches.

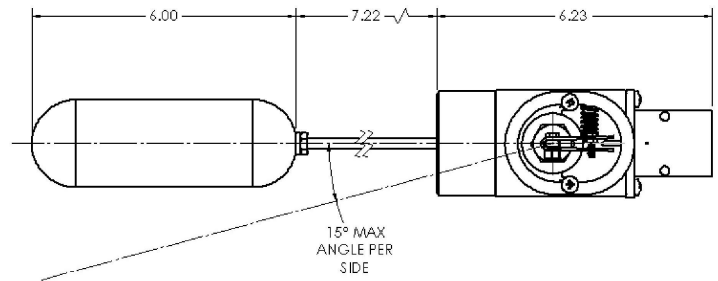

How to Order

Example Model No. **LC50P-N112**

LC50 Series Liquid Level Controller, Pneumatic, 2" NPT Connection, Standard Service, 10" Arm, 2" X 6" SST Float.

Type	
P - Pneumatic	E - Electric
Connection	
N - 2" NPT	G - 4" U - 4" Union T - 5" Union
Materials	
1 - Standard	2 - NACE
Arm Length	
1 - 10" (Standard)	6 - 6" (Optional)
Float Size	
2 - 2" X 6" SST (Standard)	3 - 3 1/2" X 6" SST (Optional)
Option	
Blank - Nothing	I - Interface

LC50P-N112